

SECOND FLOOR WARD EAST MEDICAL GAS PLAN
 SCALE: 1/8" = 1'-0"

100% SUBMITTAL
 BID SET -
 CONSTRUCTION
 DOCUMENTS
 DATE: DECEMBER, 21 2012

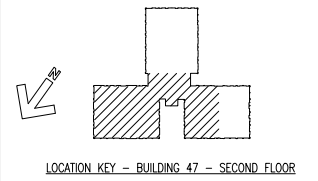

1/8"=1'-0" 0 5 10 15

FULLY SPRINKLERED

ONE-EIGHTH INCH = ONE FOOT
 ONE-FOURTH INCH = ONE FOOT
 ONE-HALF INCH = ONE FOOT
 THREE-FOURTHS INCH = ONE FOOT
 ONE INCH = ONE FOOT
 ONE AND ONE-HALF INCHES = ONE FOOT
 THREE INCHES = ONE FOOT

BY	REVISIONS	DATE



CONFIDENTIAL - THESE DRAWINGS MUST BE RETURNED TO FACILITIES MANAGEMENT SERVICE, PROJECT SECTION, UPON COMPLETION, OR FINAL USE BY THE CONTRACTOR FOR BIDDING PURPOSES.

ASBESTOS WARNING: ASBESTOS CONTAINING BUILDING MATERIALS (ACBM) ARE PRESENT THROUGHOUT THE FACILITY. IF CONTRACTORS FIND ACBM, OR SUSPECT FINDING ACBM, THEY SHALL IMMEDIATELY STOP WORK AND CONTACT THE PROJECT COTR.

SCALING NOTES: FULL SIZE V.A. 11" SHEETS (SCALE AS INDICATED) AND HALF SIZE V.A. 10" SHEETS @ THE SCALE INDICATED LETTER SIZE DRAWINGS ARE NOT TO SCALE.

GENERAL NOTE: CONTRACTORS AND ARCHITECT/ENGINEERING FIRMS ARE RESPONSIBLE FOR THE FIELD VERIFICATION OF ALL EXISTING CONDITIONS.

Project Title
**RENOVATE
 WARD 5 EAST**

Drawing Title SECOND FLOOR - WARD EAST			Date 12/21/12	
Project No. 637-11-119				
Building Number 47	Checked TMF	Drawn TPL		DRAWING NO. P106
Location ASHEVILLE, NC				Dwg 62 Of 78

