

NOTE: THIS PROJECT IS A COMPLETE RENOVATION OF THIS AREA OF THE FIFTH FLOOR. GENERALLY, ALL HOT WATER PIPING, CHILLED WATER PIPING, STEAM & CONDENSATE PIPING, SUPPLY AIR DUCTWORK, RETURN AIR DUCTWORK, AND EXHAUST AIR DUCTWORK THAT IS LOCATED ABOVE CEILING THAT IS NOT SERVING OTHER FLOORS, OR PASSING THROUGH THE FIFTH FLOOR, TO BE REMOVED WITHIN THE BOUNDARIES OF THE PROJECT. THIS DRAWING DOES NOT REPRESENT EACH AND EVERY DUCT AND PIPE THAT EXISTS IN THIS AREA THAT WILL BE REQUIRED TO BE REMOVED AND/OR RE-ROUTED. ALL PIPING AND DUCTS THAT PASS THROUGH THIS AREA, VERTICALLY AND/OR HORIZONTALLY, BUT SERVE OTHER SURROUNDING AREAS MAY NOT BE INDICATED ON THESE DRAWINGS. CONTRACTOR SHALL GENERALLY PROTECT THESE ITEMS THAT ARE TO REMAIN, BUT THESE ITEMS MAY BE REQUIRED TO BE REWORKED, RESUPPORTED, OR IN SOME CASES RELOCATED TO CLEAR NEW CONSTRUCTION OR ITEMS THAT ARE REQUIRED TO BE INSTALLED AS PART OF THIS RENOVATION.

**FIFTH FLOOR PIPING DEMOLITION PLAN**  
SCALE: 1/8"=1'-0"

**GENERAL NOTES**

- FOR LEGEND AND GENERAL NOTES SEE SHEET M001.
- EXISTING CHILLED AND HOT WATER PIPING IS LOCATED ABOVE CEILINGS UNLESS OTHERWISE SHOWN OR NOTED.
- REMOVE EXISTING CHILLED AND HOT WATER, HANGERS, VALVES, AND APPURTENANCES BACK TO THE POINT INDICATED ON THE DRAWINGS.
- PATCH ALL WALL, FLOOR AND CEILINGS TO MATCH EXISTING CONDITIONS AND RATINGS AS REQUIRED.

**DEMOLITION KEY NOTES**

- REMOVE EXISTING FAN COIL UNIT, CONTROLS, PIPING, AND ALL APPURTENANCES.
- REMOVE EXISTING HEATING UNIT, CONTROLS, PIPING, AND ALL APPURTENANCES.
- CAP HOT AND CHILLED WATER LINES INSIDE CHASE WALL. PROVIDE FIRE RATED SEAL AS REQUIRED.
- REMOVE EXISTING HOT AND CHILLED WATER LINES SERVING HEATING AND FAN COIL UNITS.
- REMOVE EXISTING HOT WATER SUPPLY AND RETURN LINES TO REHEAT BOXES.
- CAP EXISTING HOT WATER SUPPLY AND RETURN LINES AT CEILING. REMOVE HOT WATER SUPPLY AND RETURN LINES SERVING REHEAT BOXES. PROVIDE RATED SEAL AS REQUIRED.
- REMOVE EXISTING REHEAT BOX.

**DEMOLITION LINE TYPES**

- DENOTES EXISTING TO BE REMOVED.
- \_\_\_\_\_ DENOTES EXISTING TO REMAIN.

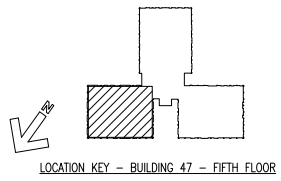

100% SUBMITTAL  
BID SET -  
CONSTRUCTION  
DOCUMENTS  
DATE: DECEMBER, 21 2012

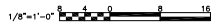

BID SET - 100% CONSTRUCTION DOCUMENTS

FULLY SPRINKLERED

BY	REVISIONS	DATE



**CONFIDENTIAL** THESE DRAWINGS MUST BE RETURNED TO FACILITIES MANAGEMENT SERVICE, PROJECT SECTION, UPON COMPLETION, OR FINAL USE BY THE CONTRACTOR FOR BIDDING PURPOSES.

**ASBESTOS WARNING:** ASBESTOS CONTAINING BUILDING MATERIALS (ACBM) ARE PRESENT THROUGHOUT THE FACILITY. IF CONTRACTORS FIND ACBM, OR SUSPECT FINDING ACBM, THEY SHALL IMMEDIATELY STOP WORK AND CONTACT THE PROJECT COTR.

**SCALING NOTES:** FULL SIZE V.A. 1/8" SHEETS (SCALE AS INDICATED) AND HALF SIZE V.A. 1/4" SHEETS @ THE SCALE INDICATED LETTER. SIZE DRAWINGS ARE NOT TO SCALE.

**GENERAL NOTE:** CONTRACTORS AND ARCHITECT/ENGINEERING FIRMS ARE RESPONSIBLE FOR THE FIELD VERIFICATION OF ALL EXISTING CONDITIONS.

Project Title  
**RENOVATE  
WARD 5 EAST**

Drawing Title <b>FIFTH FLOOR - WARD EAST EXISTING PIPING DEMOLITION PLAN</b>	Date 12/21/12
Building Number 47	Project No. 637-11-119
Checked CMH	DRAWING NO. M101
Location ASHEVILLE, NC	Dwg 47 OF 78

