

- FIRE PROTECTION GENERAL NOTES**
1. ALL DEMOLITION WORK SHALL BE IN ACCORDANCE WITH CONSTRUCTION DOCUMENTS, PROJECT SPECIFICATIONS, 2009 VA FIRE PROTECTION MANUAL, LATEST ADDITIONS OF THE NATIONALLY RECOGNIZED FIRE AND LIFE SAFETY CODES, SUCH AS BUT NOT LIMITED TO, NFPA 13, NFPA 14, NFPA 25, NFPA 101 AND NFPA 241.
 2. FIRE PROTECTION ALTERATIONS SHALL COMPLY WITH THE VA MASTER CONSTRUCTION SPECIFICATIONS.
 3. ALL DEMOLITION WORK SHALL BE ACCOMPLISHED WITHIN THE AREA OF WORK SCOPE. CONTRACTOR SHALL FIELD VERIFY WHERE DEMOLITION TO SYSTEMS ARE NECESSARY OUTSIDE OF THE AREA OF SCOPE OF WORK, TO COMPLY AND COORDINATE WITH THE SMOKE ZONE BARRIER BOUNDARY FOR A COMPLETE AND COMPLIANT SYSTEM AREA.
 4. CONTRACTOR SHALL PERFORM ALL DEMOLITION WORK IN A SAFE AND COMPLIANT MANNER. FAILURE TO COMPLY IS AT THE RISK OF THE CONTRACTOR.
 5. CONTRACTOR SHALL TAKE CARE NOT TO DAMAGE EXISTING BUILDING FEATURES ANTICIPATED TO REMAIN, SUCH AS BUT NOT LIMITED TO, WALLS, FLOORS, CEILINGS, ELEVATORS, STAIRS AND OTHER SIMILAR FEATURES. FAILURE TO COMPLY IS AT THE RISK OF THE CONTRACTOR.
 6. DISPOSE OF WASTE AND DEBRIS IN ACCORDANCE WITH NFPA 241 AND CONTRACT DOCUMENTS.
 7. MINIMIZE OR AVOID DISRUPTIONS TO THE FIRE SPRINKLER SYSTEM. WHEN DISRUPTIONS ARE ANTICIPATED, ENSURE PROCEDURES ARE INCORPORATED TO MAINTAIN EQUIVALENT LEVELS OF FIRE PROTECTION AND PROVIDE FORMAL NOTIFICATION TO THE FACILITY WHILE SYSTEMS ARE DOWN.

- FIRE PROTECTION LEGEND**
- POINT OF CONNECTION BETWEEN NEW AND EXISTING WORK
 - ▬ SMOKE ZONE BARRIER BOUNDARY

- FIRE PROTECTION KEY NOTES**
1. LOCATION OF EXISTING 6" CLASS I COMBINATION STANDPIPE RISER TO REMAIN.
 2. LOCATION OF EXISTING FLOOR CONTROL VALVE ASSEMBLY AT FLOOR LANDING LEVEL TO REMAIN.
 3. POINT OF CONNECTION. REMOVE EXISTING SYSTEM AND CONNECT NEW SYSTEM AFTER NEW SYSTEM HAS BEEN INSTALLED, INSPECTED, ACCEPTED, TESTED AND APPROVED.
 4. REMOVE AND DISCARD EXISTING HOSE VALVE CONNECTION, ASSOCIATED PIPING, AND HOSE RACK ASSEMBLY (BACK IS WITHOUT HOSE).
 5. THE EXISTING FIRE PROTECTION SYSTEM SHALL BE COMPLETELY DEMOLISHED BUT REMAIN ACTIVE DURING CONSTRUCTION AS LONG AS POSSIBLE TO PROVIDE PROTECTION. THE EXISTING SYSTEM SHALL BE ALTERED AS NECESSARY FOR COMPLIANCE. THIS WILL INCLUDE REPLACING EXISTING PENDENT SPRINKLERS WITH NEW UPRIGHT SPRINKLERS, AND RELOCATING SPRINKLERS FOR CODE COMPLIANT COVERAGE.
 6. EXISTING SPRINKLER PROTECTION IN THE STAIRWELL TO REMAIN.

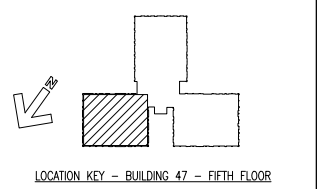

FIRE PROTECTION DEMOLITION PLAN
SCALE: 1/4" = 1'-0"

100% SUBMITTAL
BID SET - CONSTRUCTION DOCUMENTS
DATE: DECEMBER, 21 2012
1/4"=1'-0"

BID SET - 100% CONSTRUCTION DOCUMENTS
FULLY SPRINKLERED

| BY | REVISIONS | DATE |
|----|-----------|------|
| | | |
| | | |
| | | |
| | | |



CONFIDENTIAL THESE DRAWINGS MUST BE RETURNED TO FACILITIES MANAGEMENT SERVICE, PROJECT SECTION, UPON COMPLETION, OR FINAL USE BY THE CONTRACTOR FOR BIDDING PURPOSES.

ASBESTOS WARNING: ASBESTOS CONTAINING BUILDING MATERIALS (ACBM) ARE PRESENT THROUGHOUT THE FACILITY. IF CONTRACTORS FIND ACBM, OR SUSPECT FINDING ACBM, THEY SHALL IMMEDIATELY STOP WORK AND CONTACT THE PROJECT COTR.

SCALING NOTES: FULL SIZE V.A. "T" SHEETS (SCALE AS INDICATED) AND HALF SIZE V.A. "D" SHEETS (G) OF THE SCALE INDICATED LETTER SIZE DRAWINGS ARE NOT TO SCALE.

GENERAL NOTE: CONTRACTORS AND ARCHITECT/ENGINEERING FIRMS ARE RESPONSIBLE FOR THE FIELD VERIFICATION OF ALL EXISTING CONDITIONS.

Project Title
**RENOVATE
WARD 5 EAST**

| | |
|---|----------|
| Drawing Title | Date |
| FIFTH FLOOR - WARD EAST FIRE PROTECTION DEMOLITION PLAN | 12/21/12 |
| Building Number | Checked |
| 47 | CLB |
| Location | Drawn |
| ASHEVILLE, NC | MSMS |

| | |
|-------------|-------------|
| Project No. | DRAWING NO. |
| 637-11-119 | FP101 |
| Dwg | Of |
| 76 | 78 |

