

TOILET ACCESSORY LEGEND:	
TA1	PAPER TOWEL DISPENSER (NIC)
TA2	BED PAN CABINET
TA3	GLOVE DISPENSER AND HOLDERS (NIC)
TA4	TOILET TISSUE DISPENSER (CC)
TA5	GRAB BARS (CC)
TA6	SANITARY NAPKIN DISPOSAL (CC)
TA7	LINER LAVATORY GUARD (CC)
TA8	CLOTHES HOOKS, ROBE OR COAT (CC)
TA9	METAL FRAMED MIRROR (CC)
TA10	MOP RACKS, TYPE 10 (CC)
TA11	SOAP DISPENSER (NIC)
NC	NURSE CALL
CT	CURTAIN TRACK

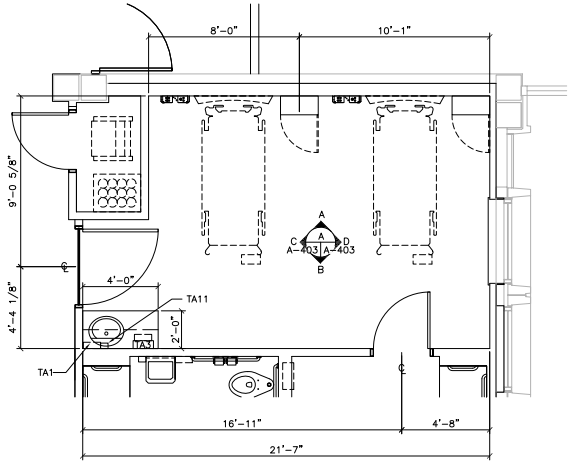

ENLARGED PLAN - BEDROOM #1 - 5E501
 SCALE: 3/8" = 1'-0"

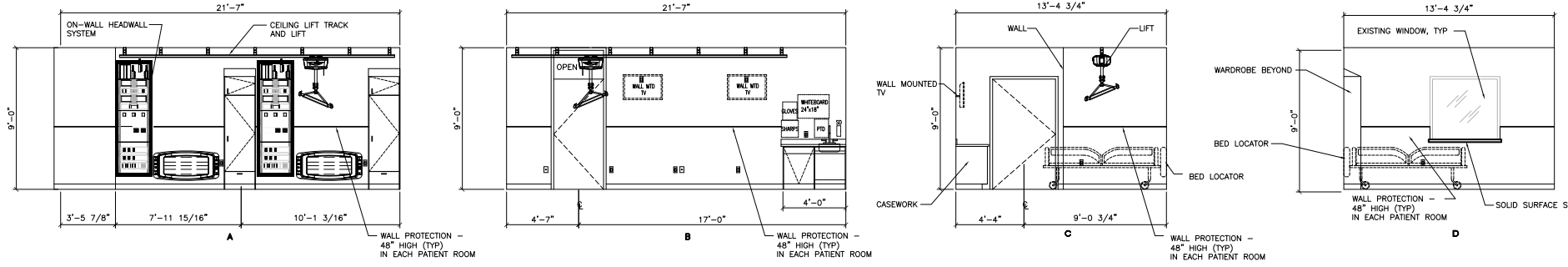

INTERIOR ELEVATIONS - BEDROOM #1 - 5E501
 SCALE: 3/8" = 1'-0"

100% SUBMITTAL
 BID SET -
 CONSTRUCTION
 DOCUMENTS
 DATE: DECEMBER, 21 2012

BID SET - 100% CONSTRUCTION DOCUMENTS

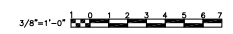

BY	REVISIONS	DATE

LINDBERGH & ASSOCIATES, LLC
 2170 Ashley Phosphate Road - Suite 504
 Charleston, South Carolina, 29406
 Phone: (843)553-6670 Fax: (843)553-0755



CONFIDENTIAL THESE DRAWINGS MUST BE RETURNED TO FACILITIES MANAGEMENT SERVICE, PROJECT SECTION, UPON COMPLETION, OR FINAL USE BY THE CONTRACTOR FOR BIDDING PURPOSES.

ASBESTOS WARNING: ASBESTOS CONTAINING BUILDING MATERIALS (ACBM) ARE PRESENT THROUGHOUT THE FACILITY. IF CONTRACTORS FIND ACBM, OR SUSPECT FINDING ACBM, THEY SHALL IMMEDIATELY STOP WORK AND CONTACT THE PROJECT COR.

SCALING NOTES: FULL SIZE V.A. T" SHEETS (SCALE AS INDICATED) AND HALF SIZE V.A. "D" SHEETS (@ THE SCALE INDICATED LETTER SIZE DRAWINGS ARE NOT TO SCALE.

GENERAL NOTE: CONTRACTORS AND ARCHITECT/ENGINEERING FIRMS ARE RESPONSIBLE FOR THE FIELD VERIFICATION OF ALL EXISTING CONDITIONS.

Project Title
**RENOVATE
 WARD 5 EAST**

Drawing Title	Date
FIFTH FLOOR - WARD EAST ENLARGED PLAN AND ELEVATIONS	12/21/12
Building Number	Checked
47	JSA
Location	Drawn
ASHEVILLE, NC	PF

Project No.	12/21/12
637-11-119	
DRAWING NO.	A-403
Dwg	29 of 78

Office of Facilities
 Department of Veterans Affairs