

- ROOF NOTES**
- COORDINATE INSTALLATION OF ANY PENETRATION INCLUDING THE NEW AIR HANDLER UNIT (AHU), NEW SUPPLY AND RETURN DUCTS AND NEW CURB TO SUPPORT THE EQUIPMENT WITH STRUCTURAL AND MECHANICAL DRAWINGS. PATCH AND REPAIR ROOF MEMBRANE AND ASSOCIATED FLASHING TO PROVIDE FOR A WATER-TIGHT INSTALLATION.
 - REFER TO STRUCTURAL DRAWINGS FOR PLATFORM, STAIR AND RAILING DETAILS.
 - CONTRACTOR SHALL ONLY USE STAIR-2.
 - ALL WORK AT ROOF SHALL BE PHASE I, SEE A-004.
 - CONTRACTOR TO COORDINATE ROOF ACCESS WITH COR PRIOR TO CONSTRUCTION.

- ROOF PLAN KEY NOTES**
- NEW AIR HANDLING UNIT. SEE STRUCTURAL AND MECHANICAL DRAWINGS.
 - NEW RETURN DUCT. SEE MECHANICAL DRAWINGS.
 - NEW SUPPLY DUCT. SEE MECHANICAL DRAWINGS.
 - PIPING SEE MECHANICAL DRAWINGS.
 - ELECTRICAL CONDUIT. SEE ELECTRICAL DRAWINGS.
 - INSTALL NEW WALK PADS FROM AC-4 TO THE AHU INCLUDED IN THIS PROJECT. COORDINATE WITH EXISTING AND PROVIDE PADS TO MATCH EXISTING.
 - REFER TO DETAIL 10/S502
 - REFER TO DETAIL 11/S502

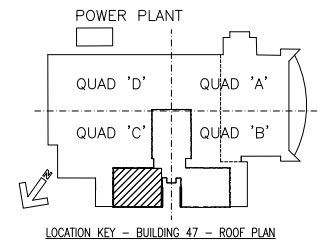

100% SUBMITTAL
 BID SET -
 CONSTRUCTION
 DOCUMENTS
 DATE: DECEMBER, 21 2012

WARD EAST ROOF PLAN
 SCALE: 1/8"=1'-0" 1/8"=1'-0" 1/8"=1'-0"

BID SET - 100% CONSTRUCTION DOCUMENTS

FULLY SPRINKLERED

| BY | REVISIONS | DATE |
|----|-----------|------|
| | | |
| | | |
| | | |
| | | |

LINDBERGH & ASSOCIATES, LLC
 2170 Ashley Phosphate Road - Suite 504
 Charleston, South Carolina, 29406
 Phone: (843)553-6670 Fax: (843)553-0755



CONFIDENTIAL THESE DRAWINGS MUST BE RETURNED TO FACILITIES MANAGEMENT SERVICE, PROJECT SECTION, UPON COMPLETION, OR FINAL USE BY THE CONTRACTOR FOR BIDDING PURPOSES.

ASBESTOS WARNING: ASBESTOS CONTAINING BUILDING MATERIALS (ACBM) ARE PRESENT THROUGHOUT THE FACILITY. IF CONTRACTORS FIND ACBM, OR SUSPECT FINDING ACBM, THEY SHALL IMMEDIATELY STOP WORK AND CONTACT THE PROJECT COR.

SCALING NOTES: FULL SIZE V.A. "T" SHEETS (SCALE AS INDICATED) AND HALF SIZE V.A. "D" SHEETS (@ THE SCALE INDICATED LETTER SIZE DRAWINGS ARE NOT TO SCALE.

GENERAL NOTE: CONTRACTORS AND ARCHITECT/ENGINEERING FIRMS ARE RESPONSIBLE FOR THE FIELD VERIFICATION OF ALL EXISTING CONDITIONS.

Project Title
**RENOVATE
 WARD 5 EAST**

| | | |
|---|-----------------------|---------------------|
| Drawing Title WARD EAST ROOF PLAN | | |
| Building Number 47 | Checked JSA | Drawn NEK |
| Location ASHEVILLE, NC | | |

| | |
|----------------------------------|--|
| Date 12/21/12 | |
| Project No. 637-11-119 | |
| DRAWING NO. A-151 | |
| Dwg 21 of 78 | |