

EQUIPMENT LIST						
EQUIP. NO.	EQUIPMENT ITEM	PROVIDED BY	CONTRACTOR PROVIDED	NO. MANUFACTURED	SPECIFICATIONS/CUT SHEETS	REMARKS
1	COMPUTER	X		X		OWNER PROVIDED
2	PRINTER	X	X			OWNER PROVIDED
3	FAX/COPIER	X	X			OWNER PROVIDED
4	NURSE CALL	X	X			OWNER PROVIDED
5	STRETCHER	X	X	X		OWNER PROVIDED
6	UPS BACK-UP	X	X			OWNER PROVIDED
7	PUSH PLATE FOR DOORS	X	X	X		ARCHITECT SPEC/ CONTRACTOR INSTALLED
8	PATIENT CEILING LIFT	X	X	X		ARCHITECT SPEC/ CONTRACTOR INSTALLED
9	TV WALL BRACKETS	X	X	X		ARCHITECT SPEC/ CONTRACTOR INSTALLED
10	PATIENT BED	X	X			OWNER PROVIDED
11	BIATRIC BED	X	X			OWNER PROVIDED
12	EYEWASH	X	X	X		PLUMBING TO PROVIDE
13	BULLETIN BOARD	X	X			OWNER PROVIDED
14	BULLETIN BOARD	X	X			OWNER PROVIDED
15	CRASH CART	X	X			OWNER PROVIDED
16	A-VITAL SIGNS MONITOR	X	X	X		OWNER PROVIDED
17	BULLETIN BOARD	X	X			OWNER PROVIDED
18	REFRIGERATOR	X	X			OWNER PROVIDED
19	MICROWAVE (COUNTER)	X	X			OWNER PROVIDED
20	ICE MACHINE (COUNTERTOP)	X	X	X		OWNER PROVIDED
21	IN-WALL HEADWALL SYSTEM	X	X	X		ARCHITECT SPEC/ CONTRACTOR INSTALLED
22	ON-WALL HEADWALL SYSTEM	X	X	X		ARCHITECT SPEC/ CONTRACTOR INSTALLED
23	LOCKERS/ DBL.TIER(ZTYP)	X	X	X		ARCHITECT SPEC/ CONTRACTOR INSTALLED
24	JANITOR'S CART	X	X			OWNER PROVIDED
25	BUILT-IN CASEWORK	X	X	X		ARCHITECT SPEC/ CONTRACTOR INSTALLED
26	FIRE EXTINGUISHER CAB.	X	X	X		ARCHITECT SPEC/ CONTRACTOR INSTALLED
27	LINEN CART	X	X			OWNER PROVIDED
28	RECYCLING CONTAINER	X	X			OWNER PROVIDED
29	FILE CABINET	X	X			OWNER PROVIDED
30	BLANKET WARMER	X	X			OWNER PROVIDED
31	TRIPLE STAINLESS STEEL GLOVE BOX HOLDER	X	X			OWNER PROVIDED
32	SECURITY PANIC BUTTON	X	X	X		OWNER PROVIDED
33	ISOLATION CART	X	X	X		OWNER PROVIDED
34	BEDPAN STORAGE	X	X	X		ARCHITECT SPEC/ CONTRACTOR INSTALLED
35	TOWEL WARMER	X	X	X		OWNER PROVIDED
36	WHITE MARKER BOARD	X	X	X		OWNER PROVIDED/ CONTRACTOR INSTALLED
37	DIGITAL WHITE BOARD	X	X			OWNER PROVIDED
38	MOP SINK	X	X	X		PLUMBING TO PROVIDE
39	CENTRAL MONITOR	X	X			OWNER PROVIDED
40	MAIL SLOT CABINET	X	X	X		ARCHITECT SPEC/ CONTRACTOR INSTALLED
41	PATIENT WARDROBE CAB.	X	X	X		ARCHITECT SPEC/ CONTRACTOR INSTALLED
42	OMNICELL UNIT	X	X			OWNER PROVIDED
43	OMNICELL UNIT	X	X			OWNER PROVIDED
44	CLINICAL SERVICE SINK	X	X	X		PLUMBING TO PROVIDE
45	SCRUBS STORAGE	X	X	X		ARCHITECT SPEC/ CONTRACTOR INSTALLED
46	REFRIGERATOR	X	X			OWNER PROVIDED
47	WHEELCHAIRS	X	X			OWNER PROVIDED
48	LINEN HAMPER	X	X			OWNER PROVIDED
49	CART	X	X			OWNER PROVIDED
50	SHARPS CONTAINER	X	X			OWNER PROVIDED
51	MOP RACK	X	X	X		ARCHITECT SPEC/ CONTRACTOR INSTALLED
52	PATIENT PRIVACY CURTAIN	X	X	X		ARCHITECT SPEC/ CONTRACTOR INSTALLED
53	OXYGEN TANK CART	X	X			OWNER PROVIDED
54	COFFEE MAKER	X	X			OWNER PROVIDED

**GENERAL NOTES**

A. CONTRACTOR TO PROVIDE STEEL SUPPORTS, OR STEEL PLATE (AT CONTRACTOR'S OPTION), BETWEEN STUDS FOR ALL HANDRAILS, ACCESSORIES, FIXTURES, BRACKETS, MONITORS, WALL HUNG CASEWORK AND MISCELLANEOUS SPECIALTIES UNLESS OTHERWISE NOTED. PROVIDE STEEL PLATES AS DETAILED FOR GRAB BARS AND CASEWORK.

B. CONTRACTOR TO PROVIDE STEEL SUPPORTS, OR STEEL PLATE (AT CONTRACTOR'S OPTION), FOR MOUNTING BRACKETS FOR ALL WALL-MOUNTED TV'S, AT 7"-0" ABOVE THE FINISHED FLOOR, UNLESS DETAILED OTHERWISE.

C. DUE TO MANUFACTURER'S VARIATION WITH SIZE OF EQUIPMENT, CASEWORK, PLUMBING FIXTURES, ETC., ALL DIMENSIONS REFERRING TO THE SPACE WHERE SUCH ITEMS ARE BUILT-IN SHALL BE VERIFIED WITH THE ITEM SUPPLIED.

D. SEE SHEET A-122 FOR EQUIPMENT #8 PATIENT LIFT TRACK LAYOUT AND DETAILS

**KEY NOTES**

1. PROVIDE TV/AV EQUIPMENT CAPABILITY THIS ROOM.

2. PROVIDE 1" CONDUIT FROM THIS LOCATION TO SECOND FLOOR DATA CLOSET FOR TELEMETRY.

100% SUBMITTAL  
 BID SET -  
 CONSTRUCTION  
 DOCUMENTS  
 DATE: DECEMBER, 21 2012

**WALL LEGEND**

EXISTING TO REMAIN

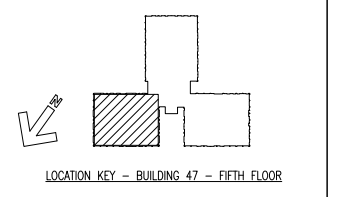

PATIENT PRIVACY ROOM MOBILE EQUIPMENT						
EQUIP. NO.	EQUIPMENT ITEM	PROVIDED BY	CONTRACTOR PROVIDED	NO. MANUFACTURED	SPECIFICATIONS/CUT SHEETS	REMARKS
6	EKG UNIT	X	X			OWNER PROVIDED
7	BLADDER SCANNER	X	X			OWNER PROVIDED
8	SCALE	X	X			OWNER PROVIDED
9	BLOOD PRESSURE MON.	X	X			OWNER PROVIDED
10	COMPUTER ON WHEELS	X	X			OWNER PROVIDED

**FIFTH FLOOR - WARD EAST - EQUIPMENT PLAN**  
 SCALE: 1/8"=1'-0" 1/8"=1'-0" 1/8"=1'-0"

BID SET - 100% CONSTRUCTION DOCUMENTS  
 FULLY SPRINKLERED

BY	REVISIONS	DATE

**LINDBERGH & ASSOCIATES, LLC**  
 2170 Ashley Phosphate Road - Suite 304  
 Charleston, South Carolina, 29406  
 Phone: (843)553-6670 Fax: (843)553-0755

**CONFIDENTIAL** THESE DRAWINGS MUST BE RETURNED TO FACILITIES MANAGEMENT SERVICE, PROJECT SECTION, UPON COMPLETION, OR FINAL USE BY THE CONTRACTOR FOR BIDDING PURPOSES.

**ASBESTOS WARNING:** ASBESTOS CONTAINING BUILDING MATERIALS (ACBM) ARE PRESENT THROUGHOUT THE FACILITY. IF CONTRACTORS FIND ACBM, OR SUSPECT FINDING ACBM, THEY SHALL IMMEDIATELY STOP WORK AND CONTACT THE PROJECT COR.

**SCALING NOTES:** FULL SIZE V.A. "T" SHEETS (SCALE AS INDICATED) AND HALF SIZE V.A. "D" SHEETS ( @ THE SCALE INDICATED LETTER SIZE DRAWINGS ARE NOT TO SCALE.

**GENERAL NOTE:** CONTRACTORS AND ARCHITECT/ENGINEERING FIRMS ARE RESPONSIBLE FOR THE FIELD VERIFICATION OF ALL EXISTING CONDITIONS.

Project Title  
**RENOVATE  
 WARD 5 EAST**

Drawing Title  
**FIFTH FLOOR - WARD EAST  
 EQUIPMENT PLAN**

Building Number: 47  
 Location: ASHEVILLE, NC

Date: 12/21/12  
 Project No.: 637-11-119  
 Drawing No.: A-103  
 Dwg 17 of 78

Office of Facilities  
 Department of Information Systems