

- NEW WORK KEY NOTES**
1. LOCATION OF HEADWALL UNIT, AND BED LOCATOR COORDINATE MEDICAL GAS AND ELECTRICAL WITH PLUMBING AND ELECTRICAL DRAWINGS.
 2. BUILT-IN SOLID SURFACE SINK WITH PLASTIC LAMINATE BASE, ACCESSORIES (N.I.C.) LOCATED AT SINK INCLUDE WHITE BOARD, SHARPS DISPOSAL BOX, GLOVE RACK, SOAP DISPENSER AND PAPER TOWEL DISPENSER. REFER TO CASEWORK ELEVATION.
 3. AFTER REMOVAL OF EXISTING FLOOR TILE AND DRAINS, PATCH ANY OPENINGS. FLOOR SUBSTRATE SHALL BE POURED LEVEL AND FLUSH AS SURROUNDING FLOOR TO RECEIVE NEW FLOOR FINISH. HATCH DENOTES AREA.
 4. PROVIDE RATED 32"x32" ACCESS PANEL 4'-4" AFF. TO CENTERLINE THROUGH WALL INTO MECHANICAL CHASE.
 5. PROVIDE 2-HOUR RATED 12"x12" ACCESS PANEL ABOVE CEILING THROUGH WALL INTO MECHANICAL CHASE FOR MEDICAL GAS. ACCESS PANEL SHALL MEET RATING REQUIREMENTS OF THE MECHANICAL CHASE (2-HOUR).
 6. REPAIR 2-HOUR RATED EXISTING WALL. COORDINATE EXTENT WITH MECHANICAL DEMOLITION DRAWINGS AND NEW WORK.
 7. CONTRACTOR SHALL VERIFY IF EXISTING WALL CONSTRUCTION IS EQUIVALENT TO A SMOKE BARRIER (1HR. FIRE RATED RESISTANCE RATED). IF NOT, CONTRACTOR SHALL PROVIDE REQUIRED PARTITION. IF ANY PENETRATIONS OR OPENINGS ARE FOUND, CONTRACTOR SHALL SEAL TO PROVIDE COMPLETE PARTITION THAT IS SMOKE TIGHT.
 8. LOCATION OF FUTURE 42" WHITE BOARD MONITOR. (N.I.C.)
 9. LOCATION OF INFORMATION BOARD. (N.I.C.)
 10. BED PAN STORAGE RECESSED IN WALL. (BY CONTRACTOR)
 11. LOCATION OF WALL-MOUNTED TV BRACKET. (BY CONTRACTOR)
 12. FURR-OUT WALL AS REQUIRED TO ACCOMMODATE EXISTING 5" RAIN WATER LEADER. REFER TO PLAN DETAILS. MAINTAIN REQUIRED CLEARANCE.

- NEW WORK GENERAL NOTES**
- A. EXISTING PARTITIONS, DOORS, WINDOWS, PLUMBING FIXTURES, CASEWORK, EQUIPMENT, ETC., ARE SHOWN AS "SCREENED" ON THE FLOOR PLANS. NEW CONSTRUCTION IS INDICATED BY SOLID LINES. REFER TO DEMOLITION DRAWINGS FOR EXTENT OF EXISTING TO BE REMOVED.
 - B. WHERE INDICATED ON THE FLOOR PLAN, FURR-OUT RATED WALL WITH 5/8" TYPE "X" GYPSUM BOARD ON 3-5/8" METAL STUDS AT 16" O.C. MAXIMUM UP TO 4" ABOVE THE FINISH CEILING IN ORDER TO PROVIDE FOR RECESSED ITEMS IN THE WALL WITHOUT INTERFERING WITH THE INTEGRITY OF THE RATED WALL.
 - C. COORDINATE LAYOUT OF FURNITURE AND EQUIPMENT, WITH COR, FURNITURE AND EQUIPMENT SHOW FOR REFERENCE ONLY.
 - D. EACH PATIENT ROOM SHALL HAVE A BEDSIDE TABLE AND GUEST RECLINER (N.I.C.), BUILT-IN WARDROBE, SINK AND WALL MOUNTED FLAT SCREEN TV (N.I.C.).
 - E. NEW SOLID SURFACE WINDOW SILLS TO BE INSTALLED AT EACH EXISTING WINDOW. FIELD VERIFY EACH LOCATION.
 - F. PROVIDE CONTINUOUS 1.5" RIGID INSULATION AND A 2-1/2" METAL STUD FURR-OUT ALONG ALL EXTERIOR PERIMETER WALLS WITH BATT INSULATION TO ACHIEVE R-11 U.I.C.O. REFER TO WALL TYPES FOR VARIATIONS.
 - G. PROVIDE ACOUSTIC BATT INSULATION WITH AN STC RATING OF 45 WITHIN WALL-IN BETWEEN EACH PATIENT ROOM, TOILETS, OFFICES, STAFF LOUNGE AND CONFERENCE ROOM.
 - H. DASHED LINE AROUND PATIENT BED DENOTES REQUIRED CLEARANCES. DASHED LINES IN TOILET ROOMS DENOTE FIXTURE CLEARANCE AND WHEELCHAIR TURNING RADIIUS.
 - I. COORDINATE PATIENT LIFT SYSTEM LOCATED AT EACH PATIENT BED WITH TRACK LEADING INTO PATIENT TOILET. BARIATRIC ROOMS SHALL HAVE BARIATRIC PATIENT LIFT AND TRACK. REFER TO REFLECTED CEILING PLAN.
 - J. PATIENT TOILET ROOM ACCESSORIES SHALL INCLUDE PAPER TOWEL DISPENSER, SOAP DISPENSER, MIRROR, SHOWER AND TOILET GRAB BARS INCLUDING DROP DOWN GRAB BAR AT TOILET, TOILET PAPER DISPENSER, FLOORS AND SHOWER SHALL SLOPE TO DRAIN. REFER TO ENLARGED FLOOR PLANS AND ELEVATIONS.
 - K. ALL RATED DOORS SHALL BE UL LISTED SMOKE RATED.

WALL LEGEND

| | |
|--|---|
| | EXISTING TO REMAIN |
| | NEW WALL |
| | SMOKE RESISTIVE, POSITIVE LATCHING |
| | SMOKE PARTITION (HAZARDOUS), 1/2 HR. LBL. CLOSER |
| | SMOKE BARRIER (1 HOUR FIRE RESISTANCE RATED), 1/2 HR. LBL. HOLD OPENS |
| | 1-HOUR FIRE RESISTANCE RATED BARRIER (HAZ.), 1/2 HR. LBL. CLOSER |
| | EXISTING TO REMAIN 2-HOUR FIRE RATED |

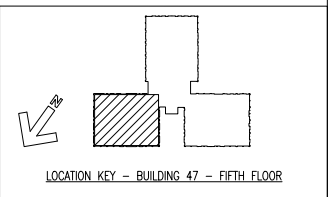

100% SUBMITTAL
 BID SET -
 CONSTRUCTION
 DOCUMENTS
 DATE: DECEMBER, 21 2012

FIFTH FLOOR - WARD EAST - NEW WORK PLAN
 SCALE: 1/8"=1'-0"

BID SET - 100% CONSTRUCTION DOCUMENTS
 FULLY SPRINKLERED

| BY | REVISIONS | DATE |
|----|-----------|------|
| | | |
| | | |
| | | |

LINDBERGH & ASSOCIATES, LLC
 2170 Ashley Phosphate Road, Suite 504
 Charleston, South Carolina, 29406
 Phone: (843)553-6670 Fax: (843)553-0755



CONFIDENTIAL THESE DRAWINGS MUST BE RETURNED TO FACILITIES MANAGEMENT SERVICE, PROJECT SECTION, UPON COMPLETION, OR FINAL USE BY THE CONTRACTOR FOR BIDDING PURPOSES.

ASBESTOS WARNING: ASBESTOS CONTAINING BUILDING MATERIALS (ACBM) ARE PRESENT THROUGHOUT THE FACILITY. IF CONTRACTORS FIND ACBM, OR SUSPECT FINDING ACBM, THEY SHALL IMMEDIATELY STOP WORK AND CONTACT THE PROJECT COR.

SCALING NOTES: FULL SIZE V.A. "T" SHEETS (SCALE AS INDICATED) AND HALF SIZE V.A. "D" SHEETS (1/2 THE SCALE INDICATED LETTER SIZE DRAWINGS ARE NOT TO SCALE).

GENERAL NOTE: CONTRACTORS AND ARCHITECT/ENGINEERING FIRMS ARE RESPONSIBLE FOR THE FIELD VERIFICATION OF ALL EXISTING CONDITIONS.

Project Title
**RENOVATE
 WARD 5 EAST**

| | | | | | |
|-----------------|-------------------------|---------|-------------|----------|-----|
| Drawing Title | FIFTH FLOOR - WARD EAST | | Date | 12/21/12 | |
| Building Number | 47 | Checked | JSA | Drawn | NEK |
| Location | ASHEVILLE, NC | | DRAWING NO. | A-101 | |
| | | | Dwg | 15 Of 78 | |

Office of Facilities
 Department of Health Services
 Division of Facilities