

**BUILDING CODE ANALYSIS**

REFERENCES:  
 2012 LIFE SAFETY CODE (NFPA 101)  
 2009 INTERNATIONAL BUILDING CODE (IBC)

TYPE OF CONSTRUCTION - NFPA 101 TABLE 18.1.6.4:  
 MINIMUM ALLOWABLE: TYPE II (222) (IBC EQUIVALENT TYPE IB)

OCCUPANCY - NFPA 101, CHAPTER 18, NEW HEALTH CARE  
 OCCUPANCIES:  
 MAJOR REHABILITATION - APPROX. 8,969 SF

NFPA 101 PARAGRAPH 18.3.3.2 - INTERIOR AND WALL CEILING FINISH REQUIREMENTS

EXIT ENCLOSURES & EXIT PASSAGEWAY	LOWER HALF OF WALL TO EXCEED 4 PERSONS	INDIVIDUAL ROOMS NOT TO A OR B
A	A OR B	A OR B

OCCUPANT LOAD - NFPA 101 18.1.7 (SLEEPING DEPARTMENT)  
 120 SQ FT/PERSON  
 PROPOSED: 8,969 SQ FT/120 SQ FT  
 ALLOWED: 75 OCCUPANTS

EGRESS CAPACITY - NFPA 101 TABLE 7.3.3.1  
 REQUIRED: 0.2 IN/OCCUPANT  
 75 OCCUPANTS X 0.2=15"  
 PROPOSED: 120"

TRAVEL DISTANCE TO EXITS - NFPA 101 PARAGRAPH 18.2.6  
 ROOM DOOR TO EXIT  
 ALLOWED: 150 FEET  
 PROPOSED: 75 FEET

POINT IN ANY ROOM TO EXIT  
 ALLOWED: 200 FEET  
 PROPOSED: 100 FEET

POINT IN ANY SLEEPING ROOM TO EXIT ACCESS DOOR  
 ALLOWED: 50 FEET  
 PROPOSED: 36 FEET

CORRIDOR FIRE-RESISTANCE RATING (HOUR)  
 NFPA 101 PARAGRAPH 18.3.6.2, TABLE 18.3.2.1  
 EXIT ACCESS CORRIDORS - SMOKE RESISTIVE  
 FIRE/SMOKE SEPARATION  
 SMOKE BARRIER 1-HOUR FIRE RESISTIVE RATED BARRIER  
 MECHANICAL CHASE - 1-HOUR FIRE RATED RESISTIVE BARRIER  
 STORAGE AREAS UP TO 100 SQUARE FEET - SMOKE PARTITION (HAZARDOUS)  
 STORAGE AREAS GREATER THAN 100 SQUARE FEET - 1-HOUR FIRE RATED RESISTIVE BARRIER (HAZARDOUS)

NFPA 101, TABLE 8.4.3.2  
 REQUIRES OPENINGS FOR SMOKE PARTITIONS TO BE 1/3-HR. FRP

NFPA 101 PARAGRAPH 18.2.3.4 -  
 EXIT ACCESS CORRIDORS - SMOKE RESISTANT CONSTRUCTION  
 CORRIDOR WIDTH NOT LESS THAN 96"  
 PROPOSED: 96"

NFPA 101 PARAGRAPH 18.2.3.6 -  
 MINIMUM CLEAR DOOR WIDTH FOR MEANS OF EGRESS  
 REQUIRED FOR HOSPITAL: 41-1/2"  
 PROPOSED: 42"

MINIMUM NUMBER OF EXITS REQUIRED:  
 NFPA 101 PARAGRAPH 18.2.4.1 -  
 MINIMUM 2  
 PROPOSED: 2 EXITS

100% SUBMITTAL  
 BID SET -  
 CONSTRUCTION  
 DOCUMENTS  
 DATE: DECEMBER, 21 2012

**DOOR LEGEND**  
 COORDINATE WITH DOOR SCHEDULE

- CLOSER
- 1/3 HR., UL, SMOKE LBL., ELEC. HOLD OPENS.
- 3/4 HR., UL, SMOKE LBL., CLOSER.
- LOCK

**WALL LEGEND**

- EXISTING TO REMAIN
- NEW WALL
- SMOKE RESISTIVE, POSITIVE LATCHING
- SMOKE PARTITION (HAZARDOUS), 1/2 HR. LBL.
- SMOKE BARRIER (1 HOUR FIRE RESISTANCE RATED), 1/2 HR. LBL, HOLD OPENS
- 1-HOUR FIRE RESISTANCE RATED BARRIER (HAZ.), 1/2 HR. LBL, CLOSER
- EXISTING TO REMAIN 2-HOUR FIRE RATED

**LEGEND SYMBOLS**

- EGRESS PATH ORIGIN
- EGRESS PATH
- EGRESS PATH END (EXIT)
- EMERGENCY EXIT
- FIRE EXTINGUISHER CABINET LOCATION
- SMOKE TIGHT WALL

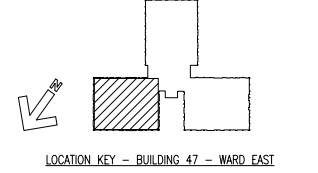

**FIFTH FLOOR - WARD EAST - LIFE SAFETY PLAN**  
 SCALE: 1/8"=1'-0" 1/8"=1'-0" 1/8"=1'-0"

BID SET - 100% CONSTRUCTION DOCUMENTS  
 FULLY SPRINKLERED

BY	REVISIONS	DATE

**LINDBERGH & ASSOCIATES, LLC**  
 2170 Ashley Phosphate Road - Suite 304  
 Charleston, South Carolina, 29406  
 Phone: (843)553-6670 Fax: (843)553-0755



**CONFIDENTIAL** THESE DRAWINGS MUST BE RETURNED TO FACILITIES MANAGEMENT SERVICE, PROJECT SECTION, UPON COMPLETION, OR FURNISH USE BY THE CONTRACTOR FOR BOOKING PURPOSES.

ASBESTOS WARNING: ASBESTOS CONTAINING BUILDING MATERIALS (ACBM) ARE PRESENT THROUGHOUT THE FACILITY. IF CONTRACTORS FIND ACBM, OR SUSPECT FINDING ACBM, THEY SHALL IMMEDIATELY STOP WORK AND CONTACT THE PROJECT COR.

SCALE NOTINGS: FULL SIZE V.A. "T" SHEETS (SCALE AS INDICATED) AND HALF SIZE V.A. "D" SHEETS (1/2 THE SCALE INDICATED LETTER SIZE DRAWINGS ARE NOT TO SCALE).

GENERAL NOTE: CONTRACTORS AND ARCHITECT/ENGINEERING FIRMS ARE RESPONSIBLE FOR THE FIELD VERIFICATION OF ALL EXISTING CONDITIONS.

Project Title  
**RENOVATE WARD 5 EAST**

Drawing Title	FIFTH FLOOR - WARD EAST	Date	12/21/12
Building Number	47	Checked	JSA
Location	ASHEVILLE, NC	Drawn	NEK

Project No. 637-11-119  
 DRAWING NO. A-005  
 Dwg 6 of 78

Office of Facilities  
 Department of Veterans Affairs